

HOW TO SORT & BULK DEPOSIT-BEARING BEVERAGE CONTAINERS

GREEN GLASS

+ 12
22

GREEN GLASS (ALCOHOL > 500 ml)

Refund to your customers: Only glass alcohol bottles over 500 ml are worth a 20-cent refund. All other glass alcohol and non-alcohol bottles are worth a 10-cent refund.

- Only non-refillable green glass alcohol bottles over 500 ml should be counted as sort/SKU 22. All other non-refillable green glass alcohol and non-alcohol bottles should be counted as sort/SKU 12.
- Mix in both sorts/SKUs 12 and 22 into the same tub or bulk bag.
- No contaminants will be tolerated in tubs or bulk bags containing glass (ceramics, hazardous waste, rocks, debris, etc.). You may be penalized if contaminants are found.



Affix *EnSys-Connex* POS shipping label to Encorp yellow tag. If no access to printer, manually fill out the tag. Make sure to indicate both sorts/SKUs and their quantities.

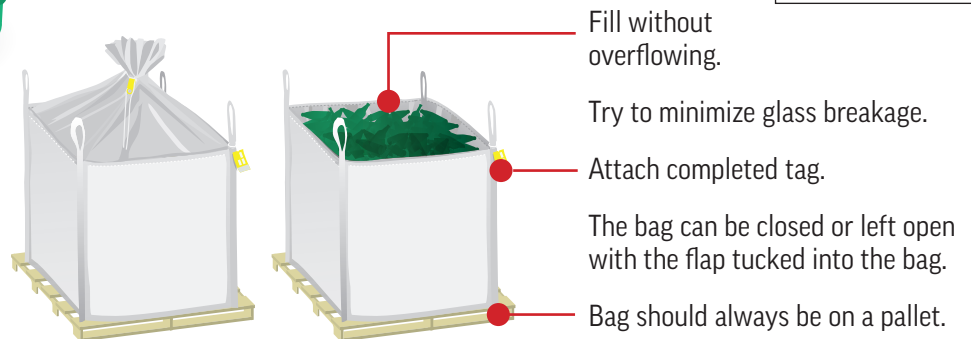
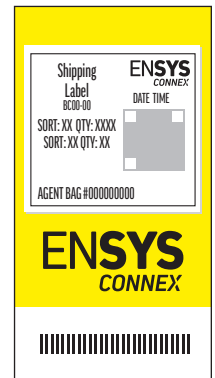

This tub (or bulk bag) gets picked up by Rayan Environmental Solutions along with all other non-refillable glass tubs and bulk bags (506-858-1600).

Drivers follow instructions provided by Encorp, and are advised not to pick up:

- Tubs (or bulk bags) that were not provided to redemption centres by Rayan.
- Tubs (or bulk bags) that are not tagged with an Encorp tag.
- Tubs (or bulk bags) that are unreasonably overfilled or underfilled.
- Tubs (or bulk bags) that are clearly filled with glass containers that are not deposit-bearing (house wines, jam jars, pickle jars, etc.) or that are contaminated (ceramics, hazardous waste, rocks, debris, etc.).